



◆ Model number

FGP30 - 66 A 1 S 2 - L XXX

1
2
3
4
5
6
7
8

- | | | | |
|--|--|---|---|
| <p>1 Series number
FGP30 series</p> <p>2 Size</p> <p>3 Position of ports
A : side ports</p> | <p>4 Port configuration
1 : flange type (SAE J518b)</p> <p>5 Mounting
S : 4 bolts frange</p> | <p>6 Shaft end
1 : SAE Spline 14 teeth</p> | <p>7 Rotation viewing from shaft end
L = counterclockwise
R = clockwise</p> <p>8 Code number in 3 figures</p> |
|--|--|---|---|

◆ Specifications

Size	Displacement		Rated pressure			Max. peak pressure			Speed min ⁻¹		Inlet pressure	Mass	
	cm ³	in ³	MPa	bar	psi	MPa	bar	psi	MIN.	MAX.		kg	lb
32	32.8	2.001	20.6	206	2987	22.6	226	3277	500	2500	bar -0.20~2.0	13.1	28.82
38	37.4	2.281										13.5	29.70
44	43.7	2.666										13.9	30.58
52	51.5	3.142										14.5	31.90
66	65.5	3.996										15.6	34.32
86	85.8	5.234										17.3	38.06
100	99.8	6.088	17.2	172	2494	20.6	206	2987	MPa -0.02~0.2	psi -2.9 ~29	18.5	40.70	

◆ Typical assembly

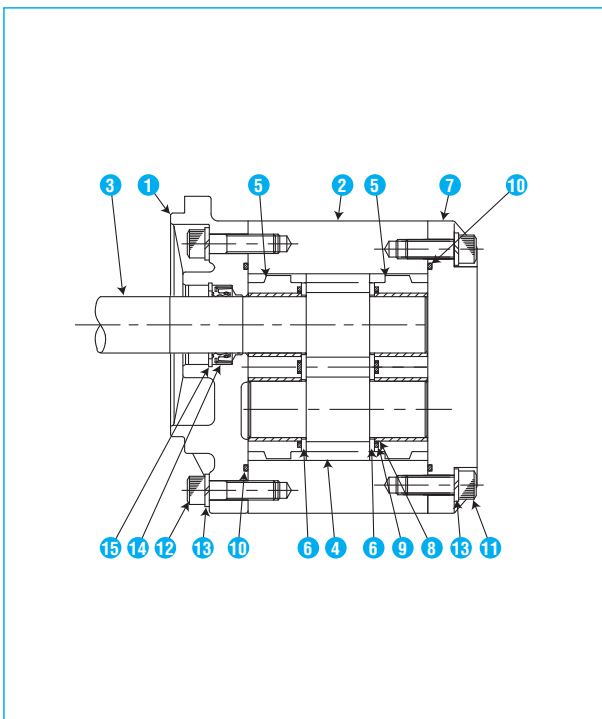

Item No.	Name	QTY	Material
1	Front cover	1	Aluminum alloy
2	Body	1	Cast iron
3	Drive gear	1	Alloy steel
4	Driven gear	1	Alloy steel
5	Bearing	2	Aluminum alloy
6	Side plate	2	Special alloy steel
7	Rear cover	1	Aluminum alloy
8	Backup strip	2	Synthetic resin
9	Gasket	2	Nitrile rubber
10	O-ring	2	Nitrile rubber
11	Bolt	8	Alloy steel
12	Bolt	8	Alloy steel
13	Washer	16	Carbon steel
14	Oil seal	1	Nitrile rubber
15	Retainer ring	1	Carbon steel

NOTES : "QTY" shows the amount per one

◆ Outline dimensions

dimensions in mm

FGP30-□A1S□-L (Side ports)

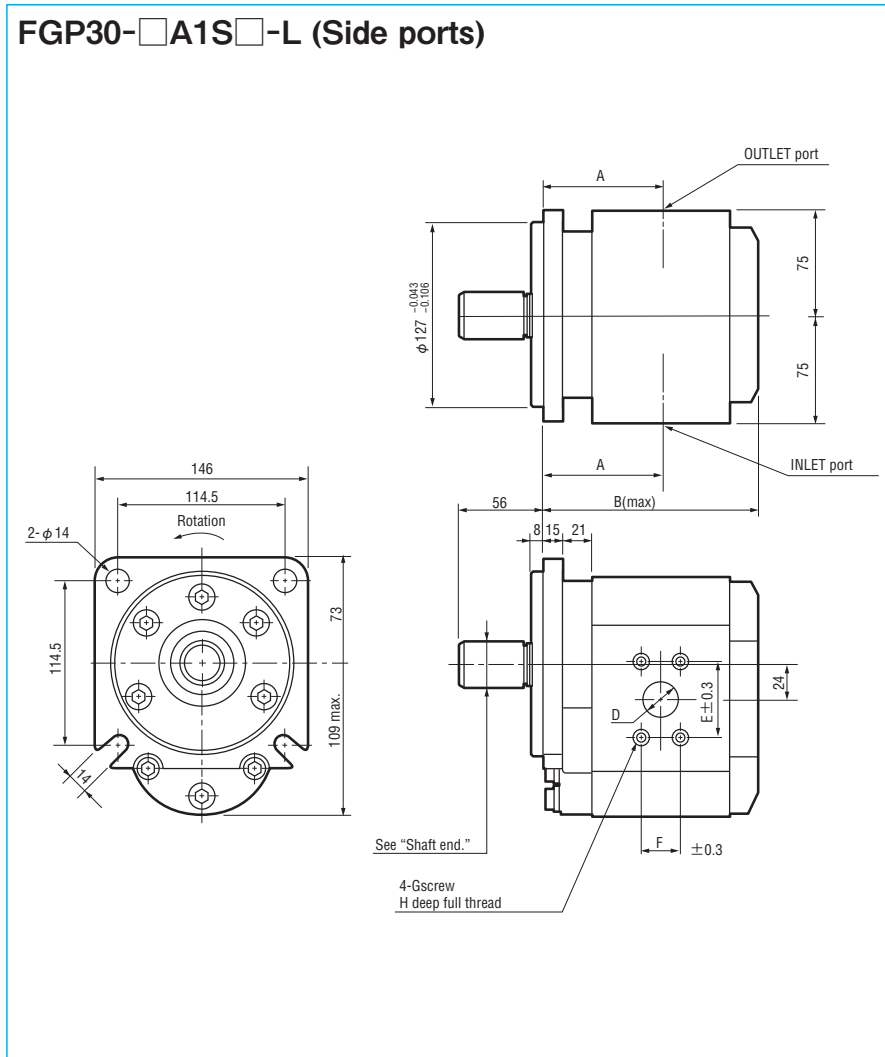

● Shaft end

SAE Spline 14 teeth

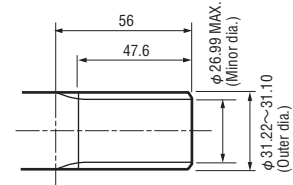

No. of tooth : 14
D.P. : 12/24
Pressure angle : 30°
Over pin dia. : 35.802~
35.695
Pin dia. : $\phi 4.064$

NOTE 1. Figure shown indicated counterclockwise rotation "L" viewing from shaft end.

Clockwise rotation "R" is mirror image of this.

2. Unless otherwise specified, tolerance on dimension are ± 1.0 mm.

Size	A	B	Inlet					Outlet				
			D	E	F	G	H	D	E	F	G	H
32	83.6	147	32	58.7	30.2	M12 (P=1.75)	20	25	52.4	26.2	M10 (P=1.5)	23
38	85.1	148										
44	87.1	152										
52	89.6	157	38	69.9	35.7	M12 (P=1.75)	20	32	58.7	30.2	M12 (P=1.75)	28
66	94.1	166										
86	103.5	186	51	77.8	42.9	M12 (P=1.75)	20	32	58.7	30.2	M12 (P=1.75)	28
100	105.1	195										

FGP30 Series Performance curves

OIL: ISO VG32 Hydraulic Fluid at 40°C

FGP30-32

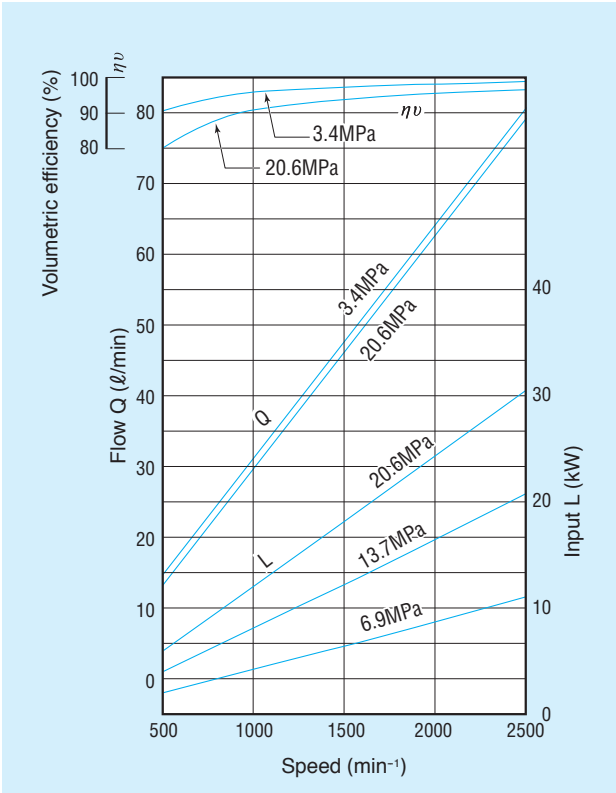

FGP30-38

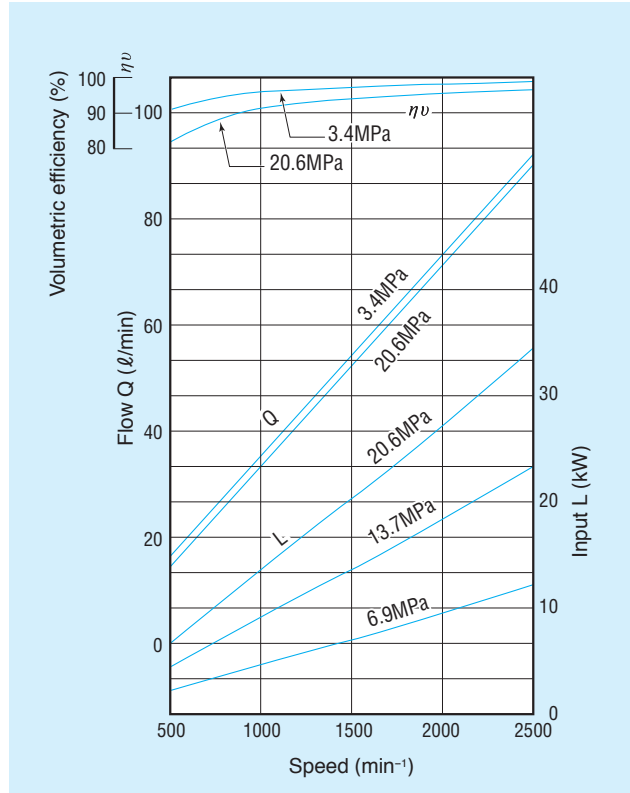

FGP30-44

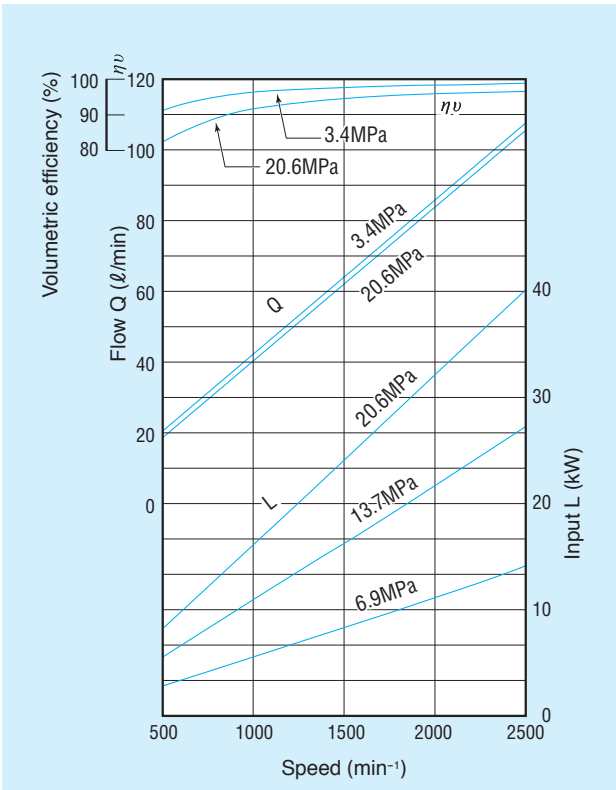

FGP30-52

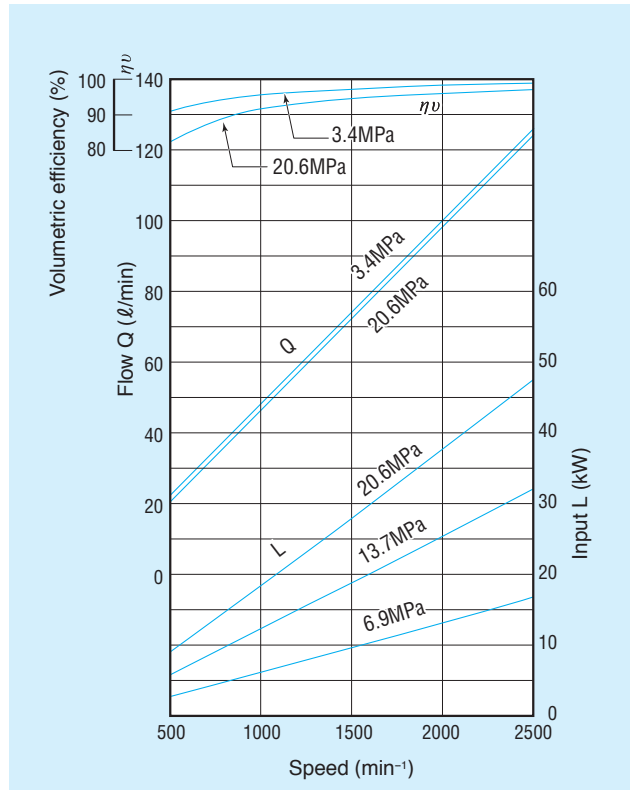

FGP30 Series Performance curves

OIL: ISO VG32 Hydraulic Fluid at 40°C

FGP30-66

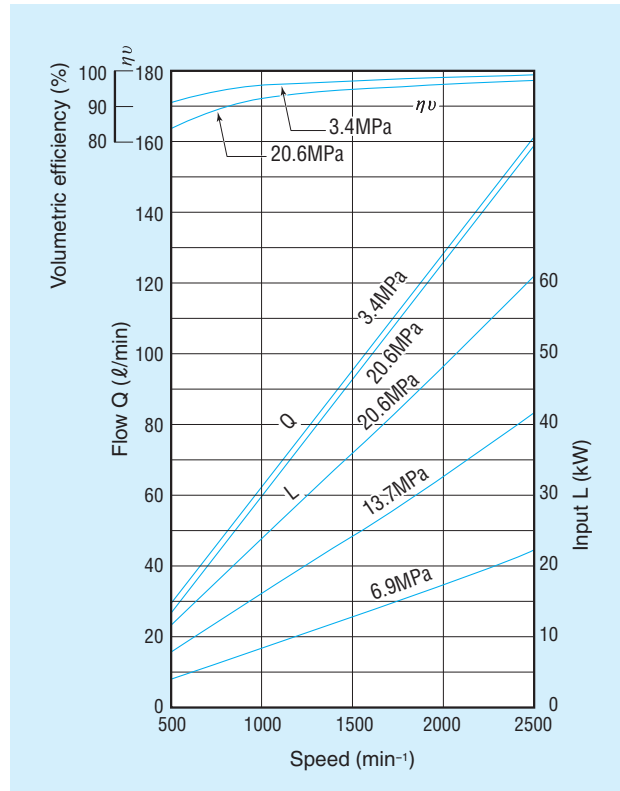

FGP30-86

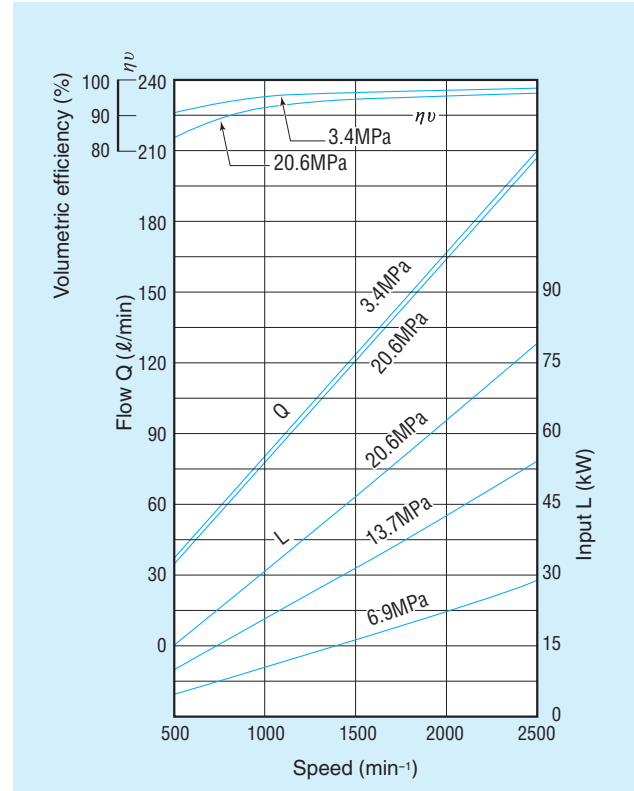

FGP30-100

